

- S-4016** (Brass finish)
- S-4152** (Chrome finish)
- CCEP-4016** (Brass finish - bulk 75 pieces - cut case carton)

## Chain Door Guard

**Contents:** 1 chain lock with keeper & installation screws.  
**Description:** **Plated steel** keeper, slide lock and chain; secures door while allowing viewing and ventilation; easy to install.  
 You may wish to stock these related parts: **S-4024**.

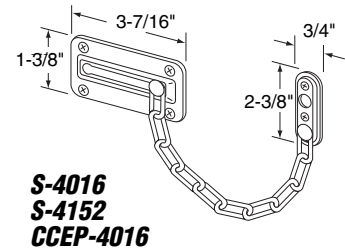
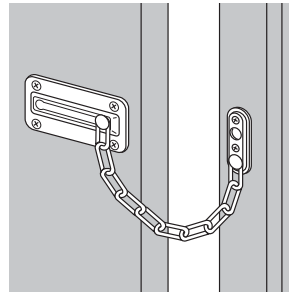

**S-4016**  
**S-4152**  
**CCEP-4016**

- S-4042** (Polished brass)
- S-4257** (Antique brass)
- S-4298** (Chrome plated)

## Chain Door Guard

**Contents:** 1 chain lock with keeper & installation screws.  
**Description:** **Solid brass** keeper and slide lock with **plated steel** chain; secures door while allowing viewing and ventilation; easy to install.  
 You may wish to stock these related parts: **S-4020**.

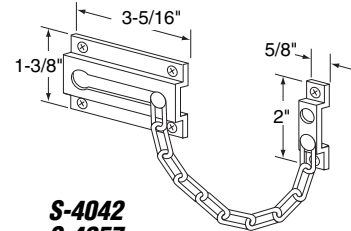
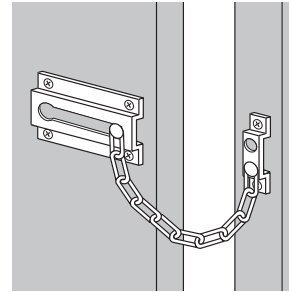

**S-4042**  
**S-4257**  
**S-4298**

- S-4177** (Polished brass)

## Chain Lock Deadbolt (Heavy duty)

**Contents:** 1 chain lock with keeper; 1 set of installation screws.  
**Description:** **Heavy duty** slide lock and keeper are made of **solid extruded brass**; **plated steel** chain; provides tamper-proof security; easy to install; slide bolt secures door in locked position.

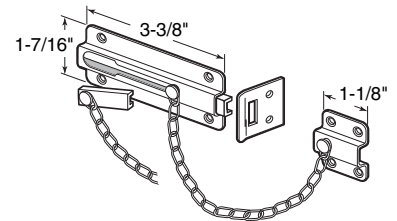
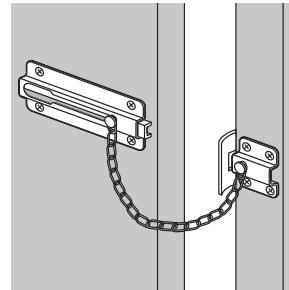

**S-4177**

- S-4275** (Brass finish)
- S-4276** (Antique brass finish)
- S-4390** (Chrome finish)

## Chain Door Guard (Keyed)

**Contents:** 1 chain lock; 2 keys; 1 set of installation screws.  
**Description:** **Plated steel** chain and **diecast** lock and keeper secure door while allowing viewing and ventilation; can be unlocked with key from outside or inside; bolt slides into keyed mechanism to lock or stores on slide bolt.

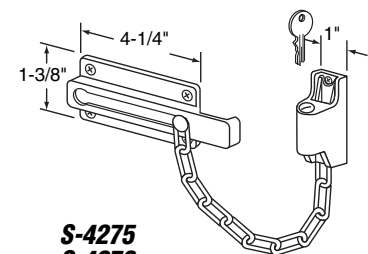
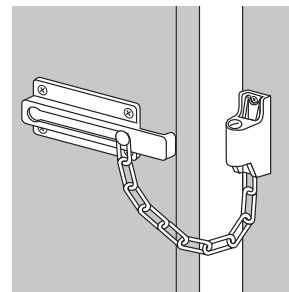

**S-4275**  
**S-4276**  
**S-4390**

- S-4351** (Brass finish)

## Chain Door Guard (With bolt)

**Contents:** 1 chain lock with keeper; 1 set of installation screws.  
**Description:** **Plated steel** keeper, slide lock and chain with **diecast** throw bolt; use of chain secures door while allowing viewing and ventilation; sliding bolt secures closed door and allows unlocking from inside only.

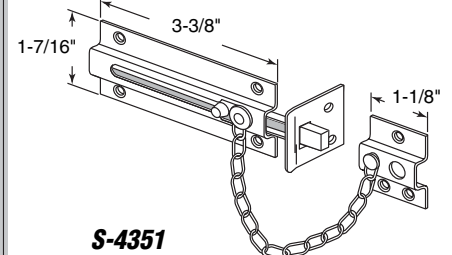
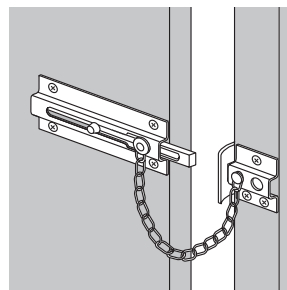

**S-4351**

**S-4385**  
**S-4386**

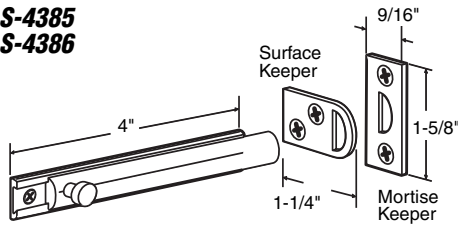

**S-4385** (4" length - polished brass)  
**S-4386** (6" length - polished brass)

**Surface Bolt**

**Contents:** 1 slide bolt; 2 keepers & installation screws.

**Description:** Solid brass slide bolt surface mounts to face of door; two keepers allow for surface or mortise frame installation.

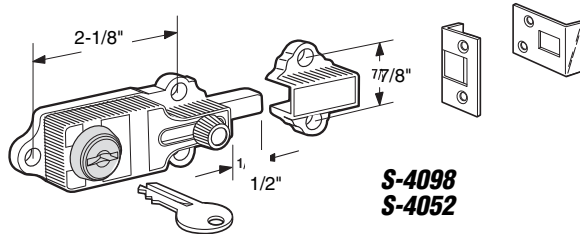

**S-4098** (Brass finish)  
**S-4052** (Chrome finish)

**Keyed Deadbolt Lock**

**Contents:** 1 lock; 3 keepers & installation screws.

**Description:** Plated diecast lock is key locked from inside; 3 keepers offer flexible mounting for both inswing and outswing doors.

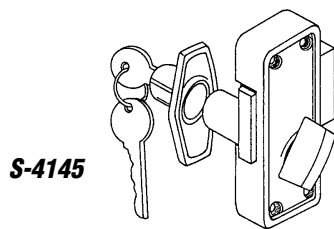

**S-4145** (Chrome finish)

**Keyed Surface Lock**

**Contents:** 1 lock assembly; 2 keys.

**Description:** Plated diecast surface mounted deadbolt lock with key cylinder; fits 7/8" to 1-3/8" thick door; thumbturn activates deadbolt from inside.

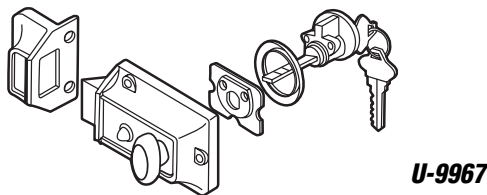

**U-9967** (Brass finish - new Defender card)

**Night Latch & Locking Cylinder**

**Contents:** 1 night latch with locking cylinder and trim ring; 2 keys; 1 mounting plate; 1 keeper and installation screws.

**Description:** Brass painted diecast locking unit and keeper; hold open feature; spring latch for automatic locking; five pin tumbler cylinder; 1-1/4" bore.

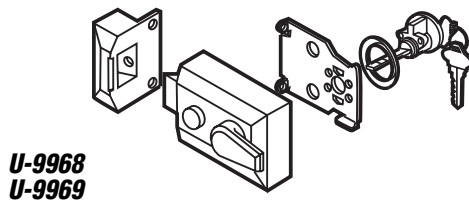

**U-9968** (Polished brass finish - new Defender card)  
**U-9969** (White finish - new Defender card)

**Night Latch & Locking Cylinder**

**Contents:** 1 night latch with locking cylinder and trim ring; 2 keys; 1 mounting plate; 1 keeper and installation screws.

**Description:** Plated and painted diecast locking unit and keeper; contemporary design; hold open feature; spring latch for automatic locking; five pin tumbler cylinder; 1-1/4" bore.

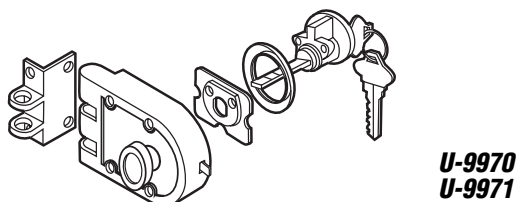

**U-9970** (Brass finish - new Defender card)  
**U-9971** (White finish - new Defender card)

**Jimmy-Resistant Deadlock** (Single cylinder)

**Contents:** 1 locking unit with locking cylinder and trim ring; 1 mounting plate; 1 keeper & installation screws.

**Description:** Painted diecast locking unit and keeper; locks door to jamb to prevent forced entry; 5-pin tumbler cylinder; requires a 1-1/4" hole; includes tamper-proof shutter guard, which insures lock integrity from outside manipulation.

- U-9972** (Brass finish - new Defender card)
- U-9973** (White finish - new Defender card)
- U-9974** (Polished brass & black finish - new Defender card)

## Jimmy-Resistant Deadlock (Double cylinder)

**Contents:** 1 locking unit with locking cylinder and trim ring; 1 mounting plate; 1 keeper & installation screws.

**Description:** Painted and plated diecast locking unit and strike; locks door to jamb to prevent forced entry; double cylinder unit is ideal for doors with glass panes or when located next to a glass side light; 5-pin tumbler cylinder requires a 1-1/4" hole; includes tamper-proof shutter guard, which insures lock integrity from outside manipulation.

**U-9972**  
**U-9973**  
**U-9974**

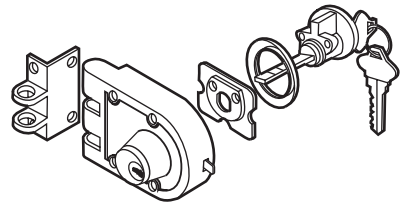

- S-4103** (Brass finish)

## Rim Cylinder Lock (Kwikset keyway)

**Contents:** 1 key cylinder with trim ring and 2 keys; 1 mounting plate and 2 screws.

**Description:** Heavy duty zinc diecast housing with brass face and 5 pin tumbler lock.

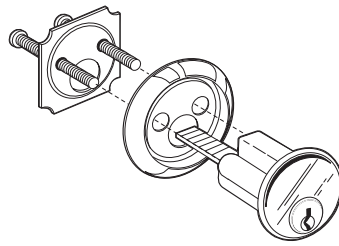

**S-4103**

- S-4060** (Aluminum finish - keyed)

- S-4061** (Aluminum finish)

## Deadbolt Loop Lock

**Contents:** 1 lock assembly; 1 strikeplate; 1 set of installation screws.

**Description:** Plated, hardened steel bolt, loops through keeper to prevent lift-out or jimmying of doors; housing is heavy zinc diecasting; thumbturn activates locking from outside.

**S-4060**  
**S-4061**

Keyed locking unit

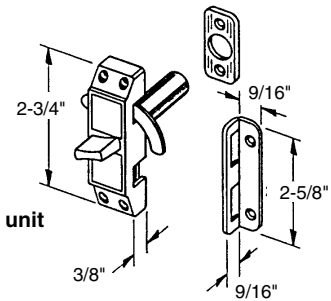

- S-4059** (Brass finish)
- S-4120** (Antique brass finish)
- S-4121** (Chrome finish)
- S-4122** (Brushed chrome finish)
- S-4424** (White finish)
- S-4429** (Satin brass finish)

## Swing Bar Lock

**Contents:** 1 swing loop keeper; 1 bar lock & installation screws.

**Description:** Plated or painted heavy zinc diecasting; secures door while allowing 2" of viewing or ventilation; easy to install.

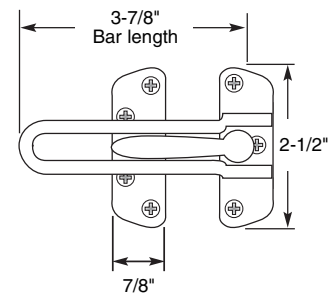
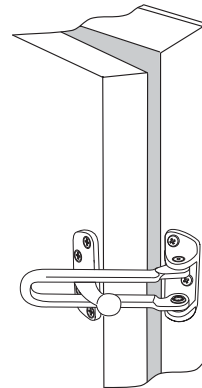

- S-4182** (Polished brass finish)

## Swing Bar Lock

**Contents:** 1 swing loop keeper; 1 bar lock; 1 set of installation screws.

**Description:** Cast brass bar lock and swing loop keeper; ball on bar lock interlocks to keeper allowing door to be opened slightly for viewing, and helps to deter forced entry; ball on swing loop keeper serves as a convenient handle.

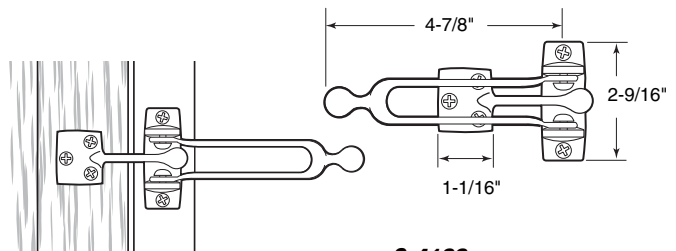

**S-4182**

**S-4183**  
**S-4184**  
**S-4353**  
**S-4430**

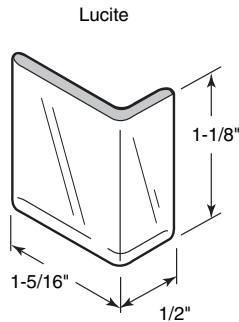
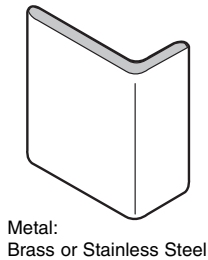
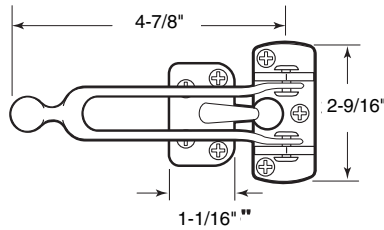

**S-4212**  
**S-4213**  
**S-4214**  
**S-4215**  
**S-4511**  
**S-4512**

**S-4183** (Polished brass)  
**S-4184** (Satin bronze finish)  
**S-4353** (Brushed chrome finish)  
**S-4430** (Satin brass finish)

**Swing Bar Lock with Edge Guard**

**Contents:** 1 swing loop keeper; 1 bar lock; 1 edge guard; 1 set of installation screws.

**Description:** Cast brass bar lock and swing loop keeper; polished or plated; ball on bar lock interlocks to keeper which allows door to be opened slightly for viewing; helps to deter forced entry; edge guard aids in reducing marring of door and frame.

**S-4212** (Clear lucite - 10 per bag)  
**S-4213** (Polished brass - 5 per bag)  
**S-4214** (Antique brass - 5 per bag)  
**S-4215** (Brushed stainless - 5 per bag)  
**S-4511** (Satin brass - 5 per bag)  
**S-4512** (Chrome finish - 5 per bag)

**Edge Guard**

**Contents:** Edge guards.

**Description:** Edge guard is adhesive backed for self-sticking application; eliminates marring of wood when lock is swung back and forth.

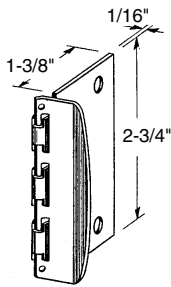

**S-4015**  
**S-4413**

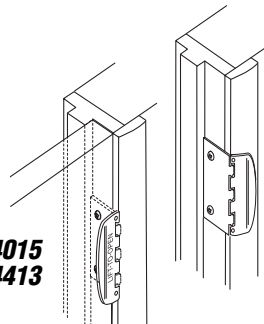

**S-4015** (Brass finish)  
**S-4413** (White finish)

**Flip Door Lock**

**Contents:** 1 lock & installation screws.

**Description:** Plated or painted steel privacy lock; flip action to lock or unlock; no mortising required; easy to install.

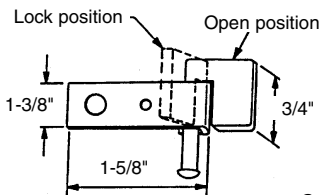

**S-4099**

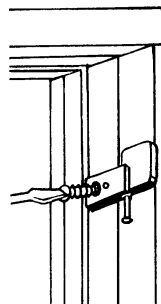

**S-4099** (Yellow zinc finish)

**Mini Flip-It Lock**

**Contents:** 1 lock; 1 set of installation fasteners.

**Description:** Plated steel installation plate and flip lock can be used on bedroom and bathroom doors as a secondary security or privacy lock; installs in seconds; easy to operate.

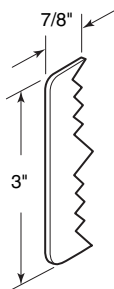

**S-4277**

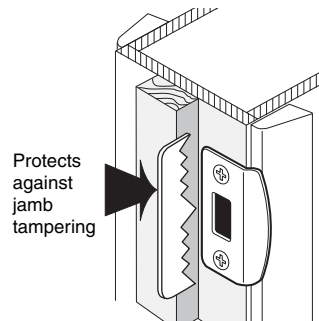

**S-4277** (Brass finish)

**Anti-Jimmy Plate**

**Contents:** 2 anti-jimmy plates.

**Description:** Plated steel plate protects against unwanted entry by use of credit cards or screwdrivers.

# Entry Door

**S-4019** (Polished brass)

**S-4178** (Polished brass - **U.L. Listed**)

**S-4365** (Satin chrome finish - **U.L. Listed**)

## Door Viewer (160°)

**Contents:** 1 viewer.

**Description:** Solid brass housing; glass or plastic lenses; fits 1-3/8" to 2" thick wood or metal doors; easy to install; glass lens viewers are **U.L. Listed**; requires 1/2" hole for installation.

**S-4019**  
**S-4178**  
**S-4365**

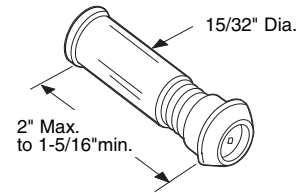
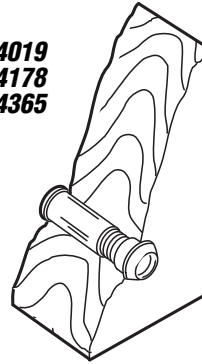

## Door Viewers

Part No.	Bore Diameter	Finish	View
S-4200	1/2"	Chrome	180°
S-4330	1/2"	Brass	190°
S-4020	9/16"	Brass	180°
CCEP-4020*	9/16"	Brass	180°
S-4153	9/16"	Satin Chrome	190°
S-4185	9/16"	Chrome	190°
S-4366	9/16"	Satin Chrome	190° U.L. Listed
S-4179	9/16"	Brass	200° U.L. Listed
S-4244	9/16"	Brass	200°

**Contents:** 1 viewer.

**Description:** Solid brass housing; glass or plastic lenses; fits 1-3/8" to 2-1/8" thick wood or metal doors; easy to install; glass lens viewers are **U.L. Listed**.

\*CCEP-4020: Bulk - 100 pieces per cut case carton.

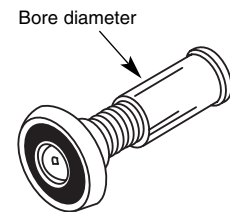
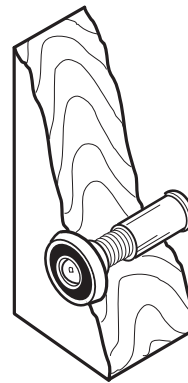

**S-4021** (Polished brass)

## Door Viewer (160°)

**Contents:** 1 viewer.

**Description:** Solid brass end caps with diecast threaded housing; glass lens; fits 1-3/8" to 2-1/8" thick wood or metal doors; easy to install; requires 1" hole for installation.

**S-4021**

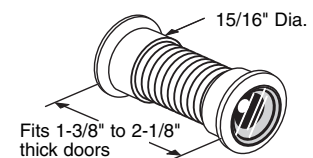
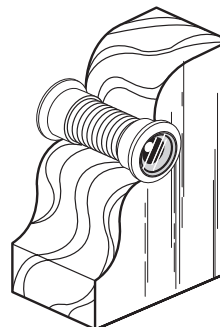

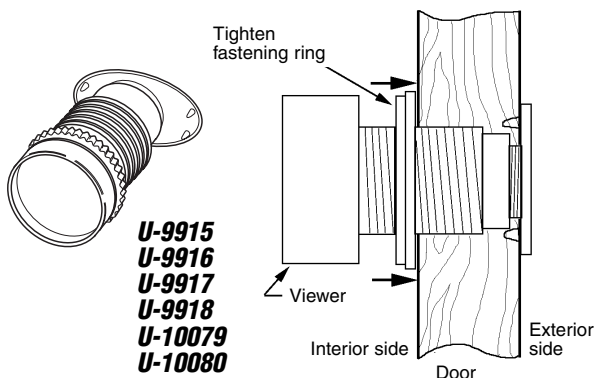

**U-9915**  
**U-9916**  
**U-9917**  
**U-9918**  
**U-10079**  
**U-10080**

**U-9915** (Gold finish)  
**U-9916** (Bronze finish)  
**U-9917** (White finish)  
**U-9918** (Gray finish)  
**U-10079** (Vacumm plated - Brass)  
**U-10080** (Vacumm plated - Chrome)

**Door Viewer**

**Contents:** 1 viewer.

**Description:** High impact plastic housing requires 1-3/4" hole; "clear image" prism construction allows arms length viewing with nearly 2" of giant screen viewing; fits 1-3/8" to 2" thick wood or metal doors; prism image is a reversed and mirrored image.

**Note:** New Defender packaging.

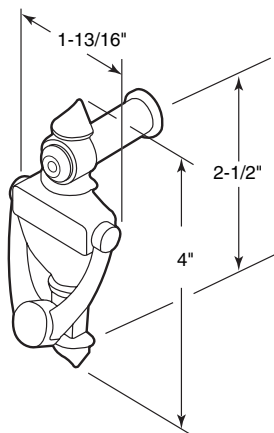

**CCEP-4090**  
**CCEP-4228**  
**CCEP-4411**

**CCEP-4090** (Brass finish)  
**CCEP-4228** (Antique brass finish)  
**CCEP-4411** (Chrome finish)

**Door Knocker and Viewer** (Poly bagged)

**Contents:** 1 knocker; 1 viewer; 1 set of installation screws.

**Description:** Diecast knocker and solid brass 160° viewer; fits doors 1-3/8" to 1-3/4" thick; requires 1/2" installation hole.

**Standard Pack:** 10 per cut case box.

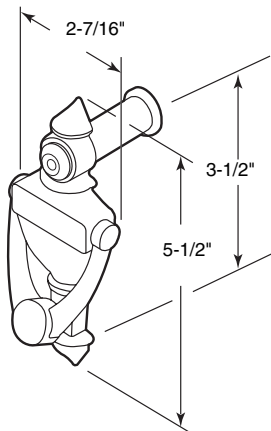

**CCEP-4234**  
**CCEP-4235**

**CCEP-4234** (Brass finish)  
**CCEP-4235** (Antique brass finish)

**Door Knocker and Viewer** (Poly bagged)

**Contents:** 1 knocker; 1 viewer; 1 set of installation screws.

**Description:** Deluxe brass door knocker and 180° viewer; fits doors 1-3/8" to 1-3/4" thick; requires 9/16" installation hole.

**Standard Pack:** 6 per cut case box.

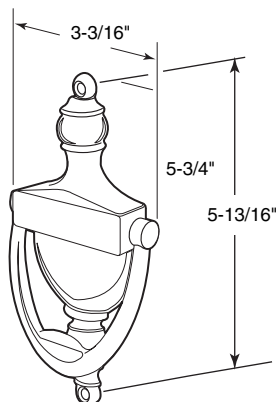

**CCEP-4089**  
**CCEP-4227**  
**CCEP-4412**

**CCEP-4089** (Brass finish)  
**CCEP-4227** (Antique brass finish)  
**CCEP-4412** (Chrome finish)

**Door Knocker** (Poly bagged)

**Contents:** 1 knocker.

**Description:** Plated diecast knocker; large traditional design.

**Standard Pack:** 6 per cut case box.