

## Ilco - Replacement Cylinders

### 15995 - Key-in-Knob / Deadbolt Combination Replacement Cylinders Universal Knob / Lever Locksets Plus Arrow & Schlage Deadbolts (Arrow Knob Designs TA, BD, DD use 1539 knob cylinder)

- 32 Available Keyways
- Arrow D, E, F, K, Schlage B100, B200, B400, H Series deadlock
- Operates most Grade 1&2 knob cylinder locksets and levers
- CL3900 Corbin Lever and Falcon T Series with tailpieces below
- 560 and 660 Schlage Deadbolts
- Screw Cap Retainer
- US4 and 26D Finish
- Solid Brass



#### Stocked Products

Keyway	Finish
Kwikset	US4, 26D
Schlage C	US4, 26D
Schlage E	US4, 26D

### 26026 Large Format IC Core - Schlage® Size

- Uncut control key included
- Cores pinned to blade height



#### Stocked Products

Item	Keyway	Finish
26026-OB W/CTL	SC	04, 26D
26026-OB W/CTL	SE	04, 26D
26026-OB W/CTL	SX(C-K)	04, 26D
26026-OB W/CTL	EA(C123)	04, 26D
26026-OB W/CTL	EB(C145)	04, 26D

## Rim Cylinders

### 7015 - Rim Cylinders

- Solid brass cylinders are ideal for use on 1-3/8" to 2-1/4" thick door.
- Each cylinder is furnished with trim ring, mounting plate & break off screws.
- All cylinders drilled 6 pin - 5 pin keyed



#### Stocked Products

Keyway	Finish
KS = Kwikset	US26D
SC = SCHLAGE C	US10B, US26D
SE = SCHLAGE E	US10B, US26D

### S2600 Series - Large Format IC Core Convertible Rim Housing - Schlage® Size

- Length: 1 1/2" (38.1mm)
- Accept Schlage® size large format interchangeable cores



#### Stocked Products

Item	Finish
S262069 RIM	26D, 10B
R2800-00-8X	
ASSORTED PARTS & ACCESSORIES KIT	

## Ilco - Replacement Cylinders

### Thumb-turn Mortise Cylinders

#### Stocked Products

7181 1-1/8" Length 10B, 26D



### Dummy Rim & Mortise Cylinders

#### Stocked Products

Dummy Rim Part # 7010 10B, 26D  
 Dummy 1-1/8" Mortise # 7180 10B, 26D  
 Dummy 1-1/4" Mortise # 7200 10B, 26D



### Mortise Cylinders

- 7165 1" Mortise Cylinder with AR cam attached
- 7185 1-1/8" Mortise Cylinder with Standard AR cam attached
- 7205 1-1/4" Mortise Cylinder with Standard cam attached

Machined from solid bar brass. This line offers a broad selection of keyways. Threadsize is 1.150" x 32 UNS. All cylinders drilled 6 pin - 5 pin keyed with standard cam



### 7165 - 1" Mortise Cylinders

#### Stocked Products

SCHLAGE C 10B, 26D

### 7185 - 1-1/8" Mortise Cylinders

#### Stocked Products

SCHLAGE C 10B, 26D  
 SCHLAGE E 10B, 26D

### 7205 - 1-1/4" Mortise Cylinders

#### Stocked Products

SCHLAGE C 10B, 26D  
 SCHLAGE E 10B, 26D

### Cams

- Cam for above 7165, 7185 and 7205. MORTISE cylinder only

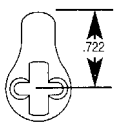

6 (863)

Standard Yale Cam

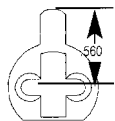

2 (863A)

Adams Rite Cam

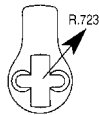

1 (863G)

Standard Cam

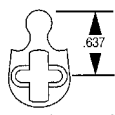

15 (863M)

Schlage L Cam

#### Stocked Products

863 Standard Yale Cam  
 863A Adams Rite Cam  
 863G Standard Cam  
 863M Schlage Lock Cam

## Ilco

### S2600 Series - Large Format IC Core Convertible Mortise Housing - Schlage® Size

- Length: 1 1/2" (38.1 mm)
- Accept Schlage® size large format interchangeable cores
- Mortise style converts to Rim using the S2600 kit (sold separately)



#### Stocked Products

Item	Cams	Finish
S265061	STD	26D, 10B
S265062	AR	26D, 10B
S265064	L	26D, 10B
S2600	CONVERT TO RIM KIT	N/A

### Adjustable Spring Collars

- 861A 5/16"-13/32" Adjustment, Brass Material, Satin Chrome



861A

### Solid Collars

- 861D 1/8" Aluminum
- 861F 1/4" Aluminum
- 861Q 3/8" Aluminum
- 861R 1/2" Aluminum



#### Stocked Products

Item	Finish
861A Adjustable Spring Collar	26D
861D Solid Collar 1/8"	ALUM , DURO
861F Solid Collar 1/4"	ALUM , DURO
861Q Solid Collar 3/8"	ALUM , DURO
861R Solid Collar 1/2"	ALUM , DURO

## Kaba Ilco - *Look Alike Key Blanks*

SCHLAGE  
100C-NP



SCHLAGE  
101C-NP



## Kaba Ilco - *Domestic*

SCHLAGE  
DND-KW1  
BR

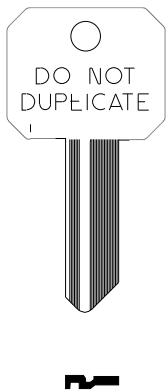

SCHLAGE  
DND-SC1  
BR

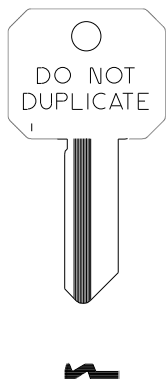

SCHLAGE  
DND-SC4  
BR

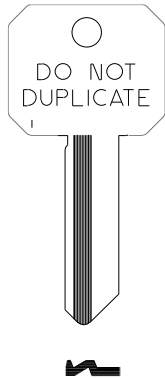

SCHLAGE  
SC1-BR  
SC1-BR-250  
SCI-NP-250

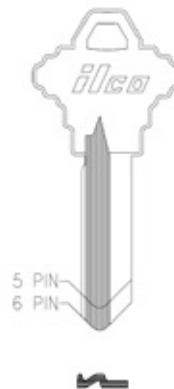

SCHLAGE  
SC4-BR  
SC4-NP  
SC4-BR-250

